

Stratford, London E15

Quality accommodation in the heart of East London



Marlin

A P A R T M E N T S

Marlin Apartments Stratford is a premium serviced apartment development in London's newest centre of commerce, meeting the increasing demand for top quality accommodation with direct access to central London.



Located in the newly rejuvenated Stratford area of East London, it is well connected by several underground lines and a railway station, and Westfield Stratford City is only five minutes' walk away. Our four-star apartments are just a five minute walk from Stratford station, providing fast transport links to central London via the underground in less than 15 minutes.

Marlin Stratford provides spacious studio, one and two bedroom apartments, as well as two bedroom penthouses. With one bedroom apartments around 425 square foot on average and two bedroom apartments in excess of 750 square feet, our serviced apartments are a welcome alternative to hotels.



Studio Apartment



Average internal area
400 sq ft / 37 sq m

One Bedroom Apartment



Average internal area
425 sq ft / 39 sq m

Two Bedroom Apartment



Average internal area
760 sq ft / 71 sq m

Two Bedroom Penthouse

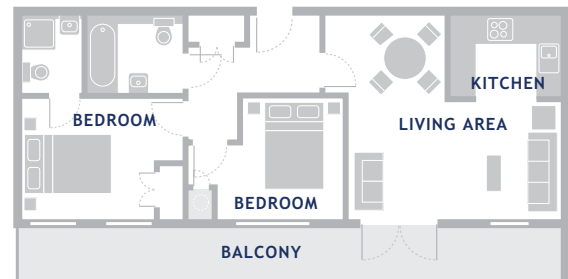

Average internal area
800 sq ft / 74 sq m

From my arrival to my departure, everything was great. Staff was very friendly and helpful, apartments were cosy and clean. It was very easy to go to central London. You get real value for money booking these apartments.

Oliviar, Turin, Italy

Plans are for illustrative purposes only, actual apartment types vary.

Facilities

- On-site car parking
- Fully-fitted kitchen including washer-dryer
- Free Wi-Fi
- Flat screen television with Freeview
- A selection of luxury L'Occitane toiletries
- Weekly housekeeping service

Local attractions

- Westfield Shopping Centre
- Queen Elizabeth Olympic Park
- The O2
- ExCel London

Travel links

- 5 minutes' walk to Stratford DLR and station
- 9 minutes by underground/DLR to ExCel London
- 11 minutes by underground to Bank
- 15 minutes by underground to London Bridge

